

**NEW
LINE**

**SOLID CARBIDE
REAMERS**



091R
supplement to
Catalog 09

GARR TOOL[®]

.0590" - .0870"
(1.49mm - 2.21mm)

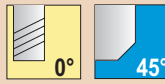

TOLERANCES		
d1	.0590" - .2509" (1.498 - 6.372mm)	+0.0002" - .0000" (+.0050 - .0000mm)
	.2510" - .5020" (6.375 - 12.750mm)	+0.0003" - .0000" (+.0075 - .0000mm)
d2	.0590" - .2509" (1.498 - 6.372mm)	+0.0002" - .0000" (+.0050 - .0000mm)
	.2510" - .5020" (6.375 - 12.750mm)	+0.0003" - .0000" (+.0075 - .0000mm)

Solid Carbide Submicron Grain
Straight - RHC Flutes
Standard 45° Lead Chamfer

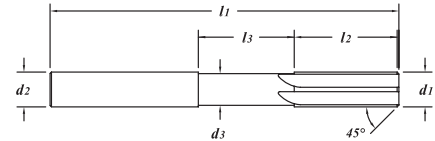

EDP#	d1 † Diameter		d2 Shank Diameter	l1 Overall Length	l2 Flute Length	l3 Neck Length	d3 Neck Diameter	Number Flutes	1-11	12-24	25-49	50-100	
	Decimal	Metric											
95066	.0590"	1.49	.0590"	1-1/2"	3/8"	.250"	.049"	4	11.79	11.28	10.76	10.25	
95069	.0591"	1.50	.0591"	1-1/2"	3/8"	.250"	.049"	4	11.79	11.28	10.76	10.25	
95072	.0595"	#53	1.51	.0595"	1-1/2"	3/8"	.250"	.050"	4	11.79	11.28	10.76	10.25
95075	.0600"		1.52	.0600"	1-1/2"	3/8"	.250"	.050"	4	11.79	11.28	10.76	10.25
95078	.0605"		1.53	.0605"	1-1/2"	3/8"	.250"	.051"	4	11.79	11.28	10.76	10.25
95081	.0610"		1.55	.0610"	1-1/2"	3/8"	.250"	.051"	4	11.79	11.28	10.76	10.25
95084	.0615"		1.56	.0615"	1-1/2"	3/8"	.250"	.052"	4	11.79	11.28	10.76	10.25
95087	.0620"		1.57	.0620"	1-1/2"	3/8"	.250"	.052"	4	11.79	11.28	10.76	10.25
95090	.0625"	1/16"	1.59	.0625"	1-1/2"	3/8"	.250"	.053"	4	11.79	11.28	10.76	10.25
95093	.0630"		1.60	.0630"	1-1/2"	3/8"	.250"	.053"	4	11.79	11.28	10.76	10.25
95096	.0635"	#52	1.61	.0635"	1-1/2"	3/8"	.250"	.054"	4	11.79	11.28	10.76	10.25
95099	.0640"		1.62	.0640"	1-1/2"	3/8"	.250"	.054"	4	11.79	11.28	10.76	10.25
95102	.0645"		1.63	.0645"	1-1/2"	3/8"	.250"	.055"	4	11.79	11.28	10.76	10.25
95105	.0650"		1.65	.0650"	1-1/2"	3/8"	.250"	.055"	4	11.79	11.28	10.76	10.25
95108	.0660"		1.67	.0660"	1-3/4"	1/2"	.250"	.056"	4	11.79	11.28	10.76	10.25
95111	.0670"	#51	1.70	.0670"	1-3/4"	1/2"	.250"	.057"	4	11.79	11.28	10.76	10.25
95114	.0680"		1.72	.0680"	1-3/4"	1/2"	.375"	.058"	4	11.79	11.28	10.76	10.25
95117	.0690"		1.75	.0690"	1-3/4"	1/2"	.375"	.059"	4	11.79	11.28	10.76	10.25
95120	.0700"	#50	1.77	.0700"	1-3/4"	1/2"	.375"	.060"	4	11.79	11.28	10.76	10.25
95123	.0710"		1.80	.0710"	1-3/4"	1/2"	.375"	.061"	4	11.79	11.28	10.76	10.25
95126	.0720"		1.82	.0720"	1-3/4"	1/2"	.375"	.062"	4	11.79	11.28	10.76	10.25
95129	.0730"	#49	1.85	.0730"	1-3/4"	1/2"	.375"	.063"	4	11.79	11.28	10.76	10.25
95132	.0740"		1.88	.0740"	1-3/4"	1/2"	.375"	.064"	4	11.79	11.28	10.76	10.25
95135	.0750"		1.90	.0750"	1-3/4"	1/2"	.375"	.065"	4	11.79	11.28	10.76	10.25
95138	.0760"	#48	1.93	.0760"	1-3/4"	1/2"	.375"	.066"	4	11.79	11.28	10.76	10.25
95141	.0770"		1.95	.0770"	1-3/4"	1/2"	.375"	.067"	4	11.79	11.28	10.76	10.25
95144	.0780"		1.98	.0780"	1-3/4"	1/2"	.375"	.068"	4	11.79	11.28	10.76	10.25
95147	.0781"	5/64"	1.98	.0781"	1-3/4"	1/2"	.375"	.068"	4	11.79	11.28	10.76	10.25
95150	.0785"	#47	1.99	.0785"	1-3/4"	1/2"	.375"	.069"	4	11.79	11.28	10.76	10.25
95153	.0787"		2.00	.0787"	1-3/4"	1/2"	.375"	.069"	4	11.79	11.28	10.76	10.25
95156	.0790"		2.01	.0790"	1-3/4"	1/2"	.375"	.069"	4	11.79	11.28	10.76	10.25
95159	.0800"		2.03	.0800"	1-3/4"	1/2"	.375"	.070"	4	11.79	11.28	10.76	10.25
95162	.0810"	#46	2.05	.0810"	2"	1/2"	.375"	.071"	4	11.79	11.28	10.76	10.25
95165	.0820"	#45	2.08	.0820"	2"	1/2"	.375"	.072"	4	11.79	11.28	10.76	10.25
95168	.0830"		2.10	.0830"	2"	1/2"	.375"	.073"	4	11.79	11.28	10.76	10.25
95171	.0840"		2.13	.0840"	2"	1/2"	.375"	.074"	4	11.79	11.28	10.76	10.25
95174	.0850"		2.16	.0850"	2"	1/2"	.375"	.075"	4	11.79	11.28	10.76	10.25
95177	.0860"	#44	2.18	.0860"	2"	1/2"	.375"	.076"	4	11.79	11.28	10.76	10.25
95180	.0870"		2.21	.0870"	2"	1/2"	.375"	.077"	4	11.79	11.28	10.76	10.25

4100 (continued)

.0880" - .1240"
(2.24mm - 3.15mm)

EDP#	d_1 † Diameter		d_2 Shank Diameter	l_1 Overall Length	l_2 Flute Length	l_3 Neck Length	d_3 Neck Diameter	Number Flutes	1-11	12-24	25-49	50-100
	Decimal	Metric										
95183	.0880"	2.24	.0880"	2"	1/2"	.375"	.078"	4	11.79	11.28	10.76	10.25
95186	.0890"	#43 2.26	.0890"	2"	1/2"	.375"	.079"	4	11.79	11.28	10.76	10.25
95189	.0900"	2.28	.0900"	2"	1/2"	.375"	.080"	4	11.79	11.28	10.76	10.25
95192	.0910"	2.31	.0910"	2"	1/2"	.375"	.081"	4	11.79	11.28	10.76	10.25
95195	.0915"	2.32	.0915"	2"	1/2"	.375"	.082"	4	11.79	11.28	10.76	10.25
95198	.0920"	2.33	.0920"	2"	1/2"	.375"	.082"	4	11.79	11.28	10.76	10.25
95201	.0925"	2.35	.0925"	2"	1/2"	.375"	.083"	4	11.79	11.28	10.76	10.25
95204	.0930"	2.36	.0930"	2"	1/2"	.375"	.083"	4	11.79	11.28	10.76	10.25
95207	.0935"	#42 2.37	.0935"	2"	1/2"	.375"	.084"	4	11.79	11.28	10.76	10.25
95210	.0938"	3/32" 2.38	.0938"	2"	1/2"	.375"	.084"	4	11.79	11.28	10.76	10.25
95213	.0940"	2.39	.0940"	2"	1/2"	.375"	.084"	4	11.79	11.28	10.76	10.25
95216	.0945"	2.40	.0945"	2"	1/2"	.375"	.085"	4	11.79	11.28	10.76	10.25
95219	.0950"	2.41	.0950"	2"	1/2"	.375"	.085"	4	11.79	11.28	10.76	10.25
95222	.0960"	#41 2.43	.0960"	2-1/4"	5/8"	.375"	.086"	4	13.26	12.68	12.11	11.53
95225	.0970"	2.46	.0970"	2-1/4"	5/8"	.375"	.087"	4	13.26	12.68	12.11	11.53
95228	.0980"	#40 2.49	.0980"	2-1/4"	5/8"	.375"	.088"	4	13.26	12.68	12.11	11.53
95231	.0984"	2.50	.0984"	2-1/4"	5/8"	.375"	.088"	4	13.26	12.68	12.11	11.53
95234	.0990"	2.51	.0990"	2-1/4"	5/8"	.500"	.089"	4	13.26	12.68	12.11	11.53
95237	.0995"	#39 2.52	.0995"	2-1/4"	5/8"	.500"	.090"	4	13.26	12.68	12.11	11.53
95240	.1000"	2.54	.1000"	2-1/4"	5/8"	.500"	.090"	4	13.26	12.68	12.11	11.53
95243	.1010"	2.56	.1010"	2-1/4"	5/8"	.500"	.091"	4	13.26	12.68	12.11	11.53
95246	.1015"	#38 2.57	.1015"	2-1/4"	5/8"	.500"	.092"	4	13.26	12.68	12.11	11.53
95249	.1020"	2.59	.1020"	2-1/4"	5/8"	.500"	.092"	4	13.26	12.68	12.11	11.53
95252	.1030"	2.61	.1030"	2-1/4"	5/8"	.500"	.093"	4	13.26	12.68	12.11	11.53
95255	.1040"	#37 2.64	.1040"	2-1/4"	5/8"	.500"	.094"	4	13.26	12.68	12.11	11.53
95258	.1050"	2.66	.1050"	2-1/4"	5/8"	.500"	.095"	4	13.26	12.68	12.11	11.53
95261	.1060"	2.69	.1060"	2-1/4"	5/8"	.500"	.096"	4	13.26	12.68	12.11	11.53
95264	.1065"	#36 2.70	.1065"	2-1/4"	5/8"	.500"	.097"	4	13.26	12.68	12.11	11.53
95267	.1070"	2.71	.1070"	2-1/4"	5/8"	.500"	.097"	4	13.26	12.68	12.11	11.53
95270	.1080"	2.74	.1080"	2-1/4"	5/8"	.500"	.098"	4	13.26	12.68	12.11	11.53
95273	.1090"	2.76	.1090"	2-1/4"	5/8"	.500"	.099"	4	13.26	12.68	12.11	11.53
95276	.1094"	7/64" 2.77	.1094"	2-1/4"	5/8"	.500"	.099"	4	13.26	12.68	12.11	11.53
95279	.1100"	#35 2.79	.1100"	2-1/4"	5/8"	.500"	.100"	4	13.36	12.78	12.20	11.62
95282	.1110"	#34 2.82	.1110"	2-1/4"	5/8"	.500"	.101"	4	13.36	12.78	12.20	11.62
95285	.1120"	2.84	.1120"	2-1/4"	5/8"	.500"	.102"	4	13.36	12.78	12.20	11.62
95288	.1130"	#33 2.87	.1130"	2-1/4"	5/8"	.500"	.103"	4	13.36	12.78	12.20	11.62
95291	.1140"	2.89	.1140"	2-1/4"	5/8"	.500"	.104"	4	13.36	12.78	12.20	11.62
95294	.1150"	2.92	.1150"	2-1/4"	5/8"	.500"	.105"	4	13.36	12.78	12.20	11.62
95297	.1160"	#32 2.94	.1160"	2-1/4"	5/8"	.500"	.106"	4	13.36	12.78	12.20	11.62
95300	.1170"	2.97	.1170"	2-1/4"	5/8"	.500"	.107"	4	13.36	12.78	12.20	11.62
95303	.1180"	2.99	.1180"	2-1/4"	5/8"	.500"	.108"	4	13.36	12.78	12.20	11.62
95306	.1181"	3.00	.1181"	2-1/4"	5/8"	.500"	.108"	4	13.36	12.78	12.20	11.62
95309	.1190"	3.02	.1190"	2-1/4"	5/8"	.500"	.109"	4	13.36	12.78	12.20	11.62
95312	.1200"	#31 3.04	.1200"	2-1/4"	5/8"	.500"	.110"	4	13.36	12.78	12.20	11.62
95315	.1210"	3.07	.1210"	2-1/4"	5/8"	.500"	.111"	4	13.36	12.78	12.20	11.62
95318	.1220"	3.09	.1220"	2-1/4"	5/8"	.500"	.112"	4	13.36	12.78	12.20	11.62
95321	.1230"	3.12	.1230"	2-1/4"	5/8"	.500"	.113"	4	13.36	12.78	12.20	11.62
95324	.1235"	3.13	.1235"	2-1/4"	5/8"	.500"	.114"	4	13.36	12.78	12.20	11.62
95327	.1240"	3.15	.1240"	2-1/4"	5/8"	.500"	.114"	4	13.36	12.78	12.20	11.62

continued →

4100 (continued)

.1245" - .1580"
(3.16mm - 4.01mm)

REAMERS

EDP#	d_1 † Diameter		d_2 Shank Diameter	l_1 Overall Length	l_2 Flute Length	l_3 Neck Length	d_3 Neck Diameter	Number Flutes	1-11	12-24	25-49	50-100
	Decimal	Metric										
95330	.1245"	3.16	.1245"	2-1/4"	5/8"	.500"	.115"	4	13.36	12.78	12.20	11.62
95333	.1248"	3.17	.1248"	2-1/4"	5/8"	.500"	.115"	4	13.36	12.78	12.20	11.62
95336	.1250"	1/8" 3.17	.1250"	2-1/4"	5/8"	.500"	.115"	4	13.36	12.78	12.20	11.62
95339	.1255"	3.18	.1255"	2-1/4"	5/8"	.500"	.116"	4	13.90	13.30	12.69	12.09
95342	.1260"	3.20	.1260"	2-1/4"	5/8"	.500"	.116"	4	13.90	13.30	12.69	12.09
95345	.1265"	3.21	.1265"	2-1/4"	5/8"	.500"	.117"	4	13.90	13.30	12.69	12.09
95348	.1270"	3.22	.1270"	2-1/4"	5/8"	.500"	.117"	4	13.90	13.30	12.69	12.09
95351	.1275"	3.23	.1275"	2-1/4"	5/8"	.500"	.118"	4	13.90	13.30	12.69	12.09
95354	.1280"	3.25	.1280"	2-1/4"	5/8"	.500"	.118"	4	13.90	13.30	12.69	12.09
95357	.1285"	#30 3.26	.1285"	2-1/4"	5/8"	.500"	.119"	4	13.90	13.30	12.69	12.09
95360	.1290"	3.27	.1290"	2-1/4"	5/8"	.500"	.119"	4	13.90	13.30	12.69	12.09
95363	.1300"	3.30	.1300"	2-1/4"	5/8"	.500"	.120"	4	13.90	13.30	12.69	12.09
95366	.1310"	3.32	.1310"	2-1/2"	3/4"	.500"	.121"	4	15.43	14.76	14.09	13.42
95369	.1320"	3.35	.1320"	2-1/2"	3/4"	.500"	.122"	4	15.43	14.76	14.09	13.42
95372	.1330"	3.37	.1330"	2-1/2"	3/4"	.500"	.123"	4	15.43	14.76	14.09	13.42
95375	.1340"	3.40	.1340"	2-1/2"	3/4"	.500"	.124"	4	15.43	14.76	14.09	13.42
95378	.1350"	3.43	.1350"	2-1/2"	3/4"	.500"	.125"	4	15.43	14.76	14.09	13.42
95381	.1360"	#29 3.45	.1360"	2-1/2"	3/4"	.500"	.126"	4	15.43	14.76	14.09	13.42
95384	.1370"	3.48	.1370"	2-1/2"	3/4"	.500"	.127"	4	15.43	14.76	14.09	13.42
95387	.1378"	3.50	.1378"	2-1/2"	3/4"	.500"	.128"	4	15.43	14.76	14.09	13.42
95390	.1380"	3.50	.1380"	2-1/2"	3/4"	.500"	.128"	4	15.43	14.76	14.09	13.42
95393	.1390"	3.53	.1390"	2-1/2"	3/4"	.500"	.129"	4	15.43	14.76	14.09	13.42
95396	.1400"	3.55	.1400"	2-1/2"	3/4"	.500"	.130"	4	15.43	14.76	14.09	13.42
95399	.1405"	#28 3.56	.1405"	2-1/2"	3/4"	.500"	.131"	4	15.43	14.76	14.09	13.42
95402	.1406"	9/64" 3.57	.1406"	2-1/2"	3/4"	.500"	.131"	4	15.43	14.76	14.09	13.42
95405	.1410"	3.58	.1410"	2-1/2"	3/4"	.500"	.131"	4	16.70	15.97	15.25	14.52
95408	.1420"	3.60	.1420"	2-1/2"	3/4"	.500"	.132"	4	16.70	15.97	15.25	14.52
95411	.1430"	3.63	.1430"	2-1/2"	3/4"	.500"	.133"	4	16.70	15.97	15.25	14.52
95414	.1440"	#27 3.65	.1440"	2-1/2"	3/4"	.500"	.134"	4	16.70	15.97	15.25	14.52
95417	.1450"	3.68	.1450"	2-1/2"	3/4"	.500"	.135"	4	16.70	15.97	15.25	14.52
95420	.1460"	3.70	.1460"	2-1/2"	3/4"	.500"	.136"	4	16.70	15.97	15.25	14.52
95423	.1470"	#26 3.73	.1470"	2-1/2"	3/4"	.500"	.137"	4	16.70	15.97	15.25	14.52
95426	.1480"	3.75	.1480"	2-1/2"	3/4"	.500"	.138"	4	16.70	15.97	15.25	14.52
95429	.1490"	3.78	.1490"	2-1/2"	3/4"	.500"	.139"	4	16.70	15.97	15.25	14.52
95432	.1495"	#25 3.79	.1495"	2-1/2"	3/4"	.500"	.140"	4	16.70	15.97	15.25	14.52
95435	.1500"	3.81	.1500"	2-1/2"	3/4"	.500"	.140"	4	16.70	15.97	15.25	14.52
95438	.1510"	3.83	.1510"	2-1/2"	3/4"	.500"	.141"	4	16.70	15.97	15.25	14.52
95441	.1520"	#24 3.86	.1520"	2-1/2"	3/4"	.500"	.142"	4	16.70	15.97	15.25	14.52
95444	.1530"	3.88	.1530"	2-1/2"	3/4"	.500"	.143"	4	16.70	15.97	15.25	14.52
95447	.1540"	#23 3.91	.1540"	2-1/2"	3/4"	.500"	.144"	4	16.70	15.97	15.25	14.52
95450	.1545"	3.92	.1545"	2-1/2"	3/4"	.500"	.145"	4	16.70	15.97	15.25	14.52
95453	.1550"	3.93	.1550"	2-1/2"	3/4"	.500"	.145"	4	16.70	15.97	15.25	14.52
95456	.1555"	3.95	.1555"	2-1/2"	3/4"	.500"	.146"	4	16.70	15.97	15.25	14.52
95459	.1560"	3.96	.1560"	2-1/2"	3/4"	.500"	.146"	4	16.70	15.97	15.25	14.52
95462	.1562"	5/32" 3.96	.1562"	2-1/2"	3/4"	.500"	.146"	4	16.70	15.97	15.25	14.52
95465	.1565"	3.97	.1565"	2-1/2"	3/4"	.500"	.147"	4	16.70	15.97	15.25	14.52
95468	.1570"	#22 3.98	.1570"	2-1/2"	3/4"	.500"	.147"	4	18.57	17.76	16.96	16.15
95471	.1575"	4.00	.1575"	2-1/2"	3/4"	.500"	.148"	4	18.57	17.76	16.96	16.15
95474	.1580"	4.01	.1580"	2-1/2"	3/4"	.500"	.148"	4	18.57	17.76	16.96	16.15

4100 (continued)

.1590" - .1970"
(4.03mm - 5.00mm)

EDP#	d_1 † Diameter		Metric	d_2 Shank Diameter	l_1 Overall Length	l_2 Flute Length	l_3 Neck Length	d_3 Neck Diameter	Number Flutes	1-11	12-24	25-49	50-100
	Decimal	#											
95477	.1590"	#21	4.03	.1590"	2-1/2"	3/4"	.500"	.149"	4	18.57	17.76	16.96	16.15
95480	.1600"		4.06	.1600"	2-3/4"	7/8"	.625"	.150"	4	18.57	17.76	16.96	16.15
95483	.1610"	#20	4.08	.1610"	2-3/4"	7/8"	.625"	.151"	4	18.57	17.76	16.96	16.15
95486	.1620"		4.11	.1620"	2-3/4"	7/8"	.625"	.152"	4	18.57	17.76	16.96	16.15
95489	.1630"		4.14	.1630"	2-3/4"	7/8"	.625"	.153"	4	18.57	17.76	16.96	16.15
95492	.1640"		4.16	.1640"	2-3/4"	7/8"	.625"	.154"	4	18.57	17.76	16.96	16.15
95495	.1650"		4.19	.1650"	2-3/4"	7/8"	.625"	.155"	4	18.57	17.76	16.96	16.15
95498	.1660"	#19	4.21	.1660"	2-3/4"	7/8"	.625"	.156"	4	18.57	17.76	16.96	16.15
95501	.1670"		4.24	.1670"	2-3/4"	7/8"	.625"	.157"	4	18.57	17.76	16.96	16.15
95504	.1680"		4.26	.1680"	2-3/4"	7/8"	.625"	.158"	4	18.57	17.76	16.96	16.15
95507	.1690"		4.29	.1690"	2-3/4"	7/8"	.625"	.159"	4	18.57	17.76	16.96	16.15
95510	.1695"	#18	4.30	.1695"	2-3/4"	7/8"	.625"	.160"	4	18.57	17.76	16.96	16.15
95513	.1700"		4.31	.1700"	2-3/4"	7/8"	.625"	.160"	4	18.57	17.76	16.96	16.15
95516	.1710"		4.34	.1710"	2-3/4"	7/8"	.625"	.161"	4	18.57	17.76	16.96	16.15
95519	.1719"	11/64"	4.36	.1719"	2-3/4"	7/8"	.625"	.162"	4	18.57	17.76	16.96	16.15
95522	.1720"		4.36	.1720"	2-3/4"	7/8"	.625"	.162"	4	18.57	17.76	16.96	16.15
95525	.1730"	#17	4.39	.1730"	2-3/4"	7/8"	.625"	.163"	4	19.32	18.48	17.64	16.80
95528	.1740"		4.42	.1740"	2-3/4"	7/8"	.625"	.164"	4	19.32	18.48	17.64	16.80
95531	.1750"		4.44	.1750"	2-3/4"	7/8"	.625"	.165"	4	19.32	18.48	17.64	16.80
95534	.1760"		4.47	.1760"	2-3/4"	7/8"	.625"	.166"	4	19.32	18.48	17.64	16.80
95537	.1770"	#16	4.49	.1770"	2-3/4"	7/8"	.625"	.167"	4	19.32	18.48	17.64	16.80
95540	.1772"		4.50	.1772"	2-3/4"	7/8"	.625"	.167"	4	19.32	18.48	17.64	16.80
95543	.1780"		4.52	.1780"	2-3/4"	7/8"	.625"	.168"	4	19.32	18.48	17.64	16.80
95546	.1790"		4.54	.1790"	2-3/4"	7/8"	.625"	.169"	4	19.32	18.48	17.64	16.80
95549	.1800"	#15	4.57	.1800"	2-3/4"	7/8"	.625"	.170"	4	19.32	18.48	17.64	16.80
95552	.1810"		4.59	.1810"	2-3/4"	7/8"	.625"	.171"	4	19.32	18.48	17.64	16.80
95555	.1820"	#14	4.62	.1820"	2-3/4"	7/8"	.625"	.172"	4	19.32	18.48	17.64	16.80
95558	.1830"		4.64	.1830"	2-3/4"	7/8"	.625"	.173"	4	19.32	18.48	17.64	16.80
95561	.1840"		4.67	.1840"	2-3/4"	7/8"	.625"	.174"	4	19.32	18.48	17.64	16.80
95564	.1850"	#13	4.70	.1850"	2-3/4"	7/8"	.625"	.175"	4	19.32	18.48	17.64	16.80
95567	.1855"		4.71	.1855"	2-3/4"	7/8"	.625"	.176"	4	19.32	18.48	17.64	16.80
95570	.1860"		4.72	.1860"	2-3/4"	7/8"	.625"	.176"	4	19.32	18.48	17.64	16.80
95573	.1865"		4.73	.1865"	2-3/4"	7/8"	.625"	.177"	4	19.32	18.48	17.64	16.80
95576	.1870"		4.75	.1870"	2-3/4"	7/8"	.625"	.177"	4	19.32	18.48	17.64	16.80
95577	.1873"		4.75	.1873"	2-3/4"	7/8"	.625"	.177"	4	19.32	18.48	17.64	16.80
95579	.1875"	3/16"	4.76	.1875"	2-3/4"	7/8"	.625"	.178"	4	19.32	18.48	17.64	16.80
95582	.1880"		4.77	.1880"	2-3/4"	7/8"	.625"	.178"	4	19.73	18.87	18.01	17.16
95585	.1885"		4.78	.1885"	2-3/4"	7/8"	.625"	.179"	4	19.73	18.87	18.01	17.16
95588	.1890"	#12	4.80	.1890"	2-3/4"	7/8"	.625"	.179"	4	19.73	18.87	18.01	17.16
95591	.1900"		4.82	.1900"	2-3/4"	7/8"	.625"	.180"	4	19.73	18.87	18.01	17.16
95594	.1910"	#11	4.85	.1910"	2-3/4"	7/8"	.625"	.181"	4	19.73	18.87	18.01	17.16
95597	.1920"		4.87	.1920"	2-3/4"	7/8"	.625"	.182"	4	19.73	18.87	18.01	17.16
95600	.1930"		4.90	.1930"	2-3/4"	7/8"	.625"	.183"	4	19.73	18.87	18.01	17.16
95603	.1935"	#10	4.91	.1935"	2-3/4"	7/8"	.625"	.184"	4	19.73	18.87	18.01	17.16
95606	.1940"		4.92	.1940"	2-3/4"	7/8"	.625"	.184"	4	19.73	18.87	18.01	17.16
95609	.1950"		4.95	.1950"	2-3/4"	7/8"	.625"	.185"	4	19.73	18.87	18.01	17.16
95612	.1960"	#9	4.97	.1960"	3"	1"	.625"	.186"	4	22.31	21.34	20.37	19.40
95615	.1969"		5.00	.1969"	3"	1"	.625"	.187"	4	22.31	21.34	20.37	19.40
95618	.1970"		5.00	.1970"	3"	1"	.625"	.187"	4	22.31	21.34	20.37	19.40

continued →

4100 (continued)

.1980" - .2400"
(5.02mm - 6.09mm)

REAMERS

EDP#	d_1 † Diameter		d_2 Shank Diameter	l_1 Overall Length	l_2 Flute Length	l_3 Neck Length	d_3 Neck Diameter	Number Flutes	1-11	12-24	25-49	50-100	
	Decimal	Metric											
95621	.1980"		5.02	.1980"	3"	1"	.625"	.188"	4	22.31	21.34	20.37	19.40
95624	.1990"	#8	5.05	.1990"	3"	1"	.625"	.189"	4	22.31	21.34	20.37	19.40
95627	.2000"		5.08	.2000"	3"	1"	.625"	.190"	4	22.31	21.34	20.37	19.40
95630	.2010"	#7	5.10	.2010"	3"	1"	.625"	.191"	4	22.31	21.34	20.37	19.40
95633	.2020"		5.13	.2020"	3"	1"	.625"	.192"	4	22.31	21.34	20.37	19.40
95636	.2030"		5.15	.2030"	3"	1"	.625"	.193"	4	22.31	21.34	20.37	19.40
95639	.2031"	13/64"	5.16	.2031"	3"	1"	.625"	.193"	4	22.31	21.34	20.37	19.40
95642	.2040"	#6	5.18	.2040"	3"	1"	.625"	.194"	4	22.31	21.34	20.37	19.40
95645	.2050"		5.20	.2050"	3"	1"	.625"	.195"	4	22.31	21.34	20.37	19.40
95648	.2055"	#5	5.22	.2055"	3"	1"	.625"	.196"	4	22.31	21.34	20.37	19.40
95651	.2060"		5.23	.2060"	3"	1"	.625"	.196"	4	22.31	21.34	20.37	19.40
95654	.2070"		5.25	.2070"	3"	1"	.625"	.197"	4	22.31	21.34	20.37	19.40
95657	.2080"		5.28	.2080"	3"	1"	.625"	.198"	4	22.31	21.34	20.37	19.40
95660	.2090"	#4	5.31	.2090"	3"	1"	.625"	.199"	4	22.31	21.34	20.37	19.40
95663	.2100"		5.33	.2100"	3"	1"	.625"	.200"	4	22.31	21.34	20.37	19.40
95666	.2110"		5.35	.2110"	3"	1"	.625"	.201"	4	22.31	21.34	20.37	19.40
95669	.2120"		5.38	.2120"	3"	1"	.625"	.202"	4	22.31	21.34	20.37	19.40
95672	.2130"	#3	5.41	.2130"	3"	1"	.625"	.203"	4	22.31	21.34	20.37	19.40
95675	.2140"		5.43	.2140"	3"	1"	.625"	.204"	4	22.31	21.34	20.37	19.40
95678	.2150"		5.46	.2150"	3"	1"	.625"	.205"	4	22.31	21.34	20.37	19.40
95681	.2160"		5.48	.2160"	3"	1"	.625"	.206"	4	22.31	21.34	20.37	19.40
95684	.2165"		5.50	.2165"	3"	1"	.625"	.207"	4	22.31	21.34	20.37	19.40
95687	.2170"		5.51	.2170"	3"	1"	.625"	.207"	4	22.31	21.34	20.37	19.40
95690	.2180"		5.53	.2180"	3"	1"	.625"	.208"	4	22.31	21.34	20.37	19.40
95693	.2188"	7/32"	5.56	.2188"	3"	1"	.625"	.209"	4	22.31	21.34	20.37	19.40
95696	.2190"		5.56	.2190"	3"	1"	.625"	.209"	4	22.31	21.34	20.37	19.40
95699	.2200"		5.58	.2200"	3"	1"	.625"	.210"	4	26.04	24.91	23.78	22.64
95702	.2210"	#2	5.61	.2210"	3"	1"	.625"	.211"	4	26.04	24.91	23.78	22.64
95705	.2220"		5.63	.2220"	3"	1"	.625"	.212"	4	26.04	24.91	23.78	22.64
95708	.2230"		5.66	.2230"	3"	1"	.625"	.213"	4	26.04	24.91	23.78	22.64
95711	.2240"		5.68	.2240"	3"	1"	.625"	.214"	4	26.04	24.91	23.78	22.64
95714	.2250"		5.71	.2250"	3"	1"	.625"	.215"	4	26.04	24.91	23.78	22.64
95717	.2260"		5.74	.2260"	3"	1"	.625"	.216"	4	26.04	24.91	23.78	22.64
95720	.2270"		5.76	.2270"	3"	1"	.625"	.217"	4	26.04	24.91	23.78	22.64
95723	.2280"	#1	5.79	.2280"	3"	1"	.625"	.218"	4	26.04	24.91	23.78	22.64
95726	.2290"		5.81	.2290"	3"	1"	.625"	.219"	4	26.04	24.91	23.78	22.64
95729	.2300"		5.84	.2300"	3"	1"	.625"	.220"	4	26.04	24.91	23.78	22.64
95732	.2310"		5.86	.2310"	3"	1"	.625"	.221"	4	26.04	24.91	23.78	22.64
95735	.2320"		5.89	.2320"	3"	1"	.625"	.222"	4	26.04	24.91	23.78	22.64
95738	.2330"		5.91	.2330"	3"	1"	.625"	.223"	4	26.04	24.91	23.78	22.64
95741	.2340"	A	5.94	.2340"	3"	1"	.625"	.224"	4	26.04	24.91	23.78	22.64
95744	.2344"	15/64"	5.95	.2344"	3"	1"	.625"	.224"	4	26.04	24.91	23.78	22.64
95747	.2350"		5.96	.2350"	3"	1"	.625"	.225"	4	27.01	25.84	24.66	23.49
95750	.2360"		5.99	.2360"	3"	1"	.625"	.226"	4	27.01	25.84	24.66	23.49
95753	.2362"		6.00	.2362"	3"	1"	.625"	.226"	4	27.01	25.84	24.66	23.49
95756	.2370"		6.02	.2370"	3"	1"	.625"	.227"	4	27.01	25.84	24.66	23.49
95759	.2380"	B	6.04	.2380"	3"	1"	.625"	.228"	4	27.01	25.84	24.66	23.49
95762	.2390"		6.07	.2390"	3"	1"	.625"	.229"	4	27.01	25.84	24.66	23.49
95765	.2400"		6.09	.2400"	3"	1"	.625"	.230"	4	27.01	25.84	24.66	23.49

4100 (continued)

.2410" - .2800"
(6.12mm - 7.11mm)

EDP#	d_1 † Diameter		d_2 Shank Diameter	l_1 Overall Length	l_2 Flute Length	l_3 Neck Length	d_3 Neck Diameter	Number Flutes	1-11	12-24	25-49	50-100
	Decimal	Metric										
95768	.2410"		.2410"	3"	1"	.625"	.231"	4	27.01	25.84	24.66	23.49
95771	.2420"	C	.2420"	3"	1"	.625"	.232"	4	27.01	25.84	24.66	23.49
95774	.2430"		.2430"	3"	1"	.625"	.233"	4	27.01	25.84	24.66	23.49
95777	.2440"		.2440"	3"	1"	.625"	.234"	4	27.01	25.84	24.66	23.49
95780	.2450"		.2450"	3"	1"	.625"	.235"	4	27.01	25.84	24.66	23.49
95783	.2460"	D	.2460"	3"	1"	.625"	.236"	4	27.01	25.84	24.66	23.49
95786	.2470"		.2470"	3"	1"	.625"	.237"	4	27.01	25.84	24.66	23.49
95789	.2480"		.2480"	3"	1"	.625"	.238"	4	27.01	25.84	24.66	23.49
95792	.2485"		.2485"	3"	1"	.625"	.239"	4	27.01	25.84	24.66	23.49
95795	.2490"		.2490"	3"	1"	.625"	.239"	4	27.01	25.84	24.66	23.49
95798	.2495"		.2495"	3"	1"	.625"	.239"	4	27.01	25.84	24.66	23.49
95799	.2498"		.2498"	3"	1"	.625"	.240"	4	27.01	25.84	24.66	23.49
95801	.2500"	1/4" / E	.2500"	3"	1"	.625"	.240"	4	27.01	25.84	24.66	23.49
95802	.2502"		.2502"	3"	1"	.625"	.240"	4	27.01	25.84	24.66	23.49
95804	.2505"		.2505"	3"	1"	.625"	.240"	4	27.01	25.84	24.66	23.49
95807	.2510"		.2510"	3"	1"	.625"	.241"	4	27.01	25.84	24.66	23.49
95810	.2515"		.2515"	3"	1"	.625"	.242"	4	27.01	25.84	24.66	23.49
95813	.2520"		.2520"	3"	1"	.625"	.242"	4	27.01	25.84	24.66	23.49
95816	.2530"		.2530"	3"	1"	.625"	.243"	4	27.01	25.84	24.66	23.49
95819	.2540"		.2540"	3"	1"	.625"	.244"	4	27.01	25.84	24.66	23.49
95822	.2550"		.2550"	3-1/4"	1-1/8"	.625"	.245"	6	31.13	29.78	28.42	27.07
95825	.2559"		.2559"	3-1/4"	1-1/8"	.625"	.246"	6	31.13	29.78	28.42	27.07
95828	.2560"		.2560"	3-1/4"	1-1/8"	.625"	.246"	6	31.13	29.78	28.42	27.07
95831	.2570"	F	.2570"	3-1/4"	1-1/8"	.625"	.247"	6	31.13	29.78	28.42	27.07
95834	.2580"		.2580"	3-1/4"	1-1/8"	.625"	.248"	6	31.13	29.78	28.42	27.07
95837	.2590"		.2590"	3-1/4"	1-1/8"	.625"	.249"	6	31.13	29.78	28.42	27.07
95840	.2600"		.2600"	3-1/4"	1-1/8"	.625"	.250"	6	31.13	29.78	28.42	27.07
95843	.2610"	G	.2610"	3-1/4"	1-1/8"	.625"	.251"	6	31.13	29.78	28.42	27.07
95846	.2620"		.2620"	3-1/4"	1-1/8"	.625"	.252"	6	31.13	29.78	28.42	27.07
95849	.2630"		.2630"	3-1/4"	1-1/8"	.625"	.253"	6	31.13	29.78	28.42	27.07
95852	.2640"		.2640"	3-1/4"	1-1/8"	.625"	.254"	6	31.13	29.78	28.42	27.07
95855	.2650"		.2650"	3-1/4"	1-1/8"	.625"	.255"	6	31.13	29.78	28.42	27.07
95858	.2656"	17/64"	.2656"	3-1/4"	1-1/8"	.625"	.256"	6	31.13	29.78	28.42	27.07
95861	.2660"	H	.2660"	3-1/4"	1-1/8"	.625"	.256"	6	31.13	29.78	28.42	27.07
95864	.2670"		.2670"	3-1/4"	1-1/8"	.625"	.257"	6	31.13	29.78	28.42	27.07
95867	.2680"		.2680"	3-1/4"	1-1/8"	.625"	.258"	6	31.13	29.78	28.42	27.07
95870	.2690"		.2690"	3-1/4"	1-1/8"	.625"	.259"	6	31.13	29.78	28.42	27.07
95873	.2700"		.2700"	3-1/4"	1-1/8"	.625"	.260"	6	31.13	29.78	28.42	27.07
95876	.2710"		.2710"	3-1/4"	1-1/8"	.625"	.261"	6	31.13	29.78	28.42	27.07
95879	.2720"	I	.2720"	3-1/4"	1-1/8"	.750"	.262"	6	31.44	30.07	28.71	27.34
95882	.2730"		.2730"	3-1/4"	1-1/8"	.750"	.263"	6	31.44	30.07	28.71	27.34
95885	.2740"		.2740"	3-1/4"	1-1/8"	.750"	.264"	6	31.44	30.07	28.71	27.34
95888	.2750"		.2750"	3-1/4"	1-1/8"	.750"	.265"	6	31.44	30.07	28.71	27.34
95891	.2756"		.2756"	3-1/4"	1-1/8"	.750"	.266"	6	31.44	30.07	28.71	27.34
95894	.2760"		.2760"	3-1/4"	1-1/8"	.750"	.266"	6	31.44	30.07	28.71	27.34
95897	.2770"	J	.2770"	3-1/4"	1-1/8"	.750"	.267"	6	31.44	30.07	28.71	27.34
95900	.2780"		.2780"	3-1/4"	1-1/8"	.750"	.268"	6	31.44	30.07	28.71	27.34
95903	.2790"		.2790"	3-1/4"	1-1/8"	.750"	.269"	6	31.44	30.07	28.71	27.34
95906	.2800"		.2800"	3-1/4"	1-1/8"	.750"	.270"	6	31.44	30.07	28.71	27.34

continued →

4100 (continued)

.2810" - .3210"
(7.14mm - 8.15mm)

REAMERS

EDP#	d_1 † Diameter		Metric	d_2 Shank Diameter	l_1 Overall Length	l_2 Flute Length	l_3 Neck Length	d_3 Neck Diameter	Number Flutes	1-11	12-24	25-49	50-100
	Decimal												
95909	.2810"	K	7.14	.2810"	3-1/4"	1-1/8"	.750"	.271"	6	31.44	30.07	28.71	27.34
95912	.2812"	9/32"	7.14	.2812"	3-1/4"	1-1/8"	.750"	.271"	6	31.44	30.07	28.71	27.34
95915	.2820"		7.16	.2820"	3-1/4"	1-1/8"	.750"	.272"	6	34.03	32.55	31.07	29.59
95918	.2830"		7.18	.2830"	3-1/4"	1-1/8"	.750"	.273"	6	34.03	32.55	31.07	29.59
95921	.2840"		7.21	.2840"	3-1/4"	1-1/8"	.750"	.274"	6	34.03	32.55	31.07	29.59
95924	.2850"		7.23	.2850"	3-1/4"	1-1/8"	.750"	.275"	6	34.03	32.55	31.07	29.59
95927	.2860"		7.26	.2860"	3-1/4"	1-1/8"	.750"	.276"	6	34.03	32.55	31.07	29.59
95930	.2870"		7.28	.2870"	3-1/4"	1-1/8"	.750"	.277"	6	34.03	32.55	31.07	29.59
95933	.2880"		7.31	.2880"	3-1/4"	1-1/8"	.750"	.278"	6	34.03	32.55	31.07	29.59
95936	.2890"		7.34	.2890"	3-1/4"	1-1/8"	.750"	.279"	6	34.29	32.80	31.31	29.82
95939	.2900"	L	7.37	.2900"	3-1/4"	1-1/8"	.750"	.280"	6	34.29	32.80	31.31	29.82
95942	.2910"		7.39	.2910"	3-1/4"	1-1/8"	.750"	.281"	6	34.29	32.80	31.31	29.82
95945	.2920"		7.41	.2920"	3-1/4"	1-1/8"	.750"	.282"	6	34.29	32.80	31.31	29.82
95948	.2930"		7.44	.2930"	3-1/4"	1-1/8"	.750"	.283"	6	34.29	32.80	31.31	29.82
95951	.2940"		7.46	.2940"	3-1/4"	1-1/8"	.750"	.284"	6	34.29	32.80	31.31	29.82
95954	.2950"	M	7.49	.2950"	3-1/4"	1-1/8"	.750"	.285"	6	34.29	32.80	31.31	29.82
95957	.2953"		7.50	.2953"	3-1/4"	1-1/8"	.750"	.285"	6	34.29	32.80	31.31	29.82
95960	.2960"		7.51	.2960"	3-1/4"	1-1/8"	.750"	.286"	6	34.29	32.80	31.31	29.82
95963	.2969"	19/64"	7.54	.2969"	3-1/4"	1-1/8"	.750"	.287"	6	34.29	32.80	31.31	29.82
95966	.2970"		7.54	.2970"	3-1/4"	1-1/8"	.750"	.287"	6	34.29	32.80	31.31	29.82
95969	.2980"		7.56	.2980"	3-1/4"	1-1/8"	.750"	.288"	6	34.29	32.80	31.31	29.82
95972	.2990"		7.59	.2990"	3-1/4"	1-1/8"	.750"	.289"	6	34.29	32.80	31.31	29.82
95975	.3000"		7.62	.3000"	3-1/4"	1-1/8"	.750"	.290"	6	34.29	32.80	31.31	29.82
95978	.3010"		7.64	.3010"	3-1/4"	1-1/8"	.750"	.291"	6	34.29	32.80	31.31	29.82
95981	.3020"	N	7.67	.3020"	3-1/4"	1-1/8"	.750"	.292"	6	34.29	32.80	31.31	29.82
95984	.3030"		7.69	.3030"	3-1/4"	1-1/8"	.750"	.293"	6	34.29	32.80	31.31	29.82
95987	.3040"		7.72	.3040"	3-1/4"	1-1/8"	.750"	.294"	6	34.29	32.80	31.31	29.82
95990	.3050"		7.74	.3050"	3-1/4"	1-1/8"	.750"	.295"	6	34.29	32.80	31.31	29.82
95993	.3060"		7.77	.3060"	3-1/4"	1-1/8"	.750"	.296"	6	34.29	32.80	31.31	29.82
95996	.3070"		7.79	.3070"	3-1/4"	1-1/8"	.750"	.297"	6	34.29	32.80	31.31	29.82
95999	.3080"		7.82	.3080"	3-1/4"	1-1/8"	.750"	.298"	6	34.29	32.80	31.31	29.82
96002	.3090"		7.84	.3090"	3-1/4"	1-1/8"	.750"	.299"	6	34.29	32.80	31.31	29.82
96005	.3100"		7.87	.3100"	3-1/4"	1-1/8"	.750"	.300"	6	34.29	32.80	31.31	29.82
96006	.3105"		7.88	.3105"	3-1/4"	1-1/8"	.750"	.300"	6	34.29	32.80	31.31	29.82
96008	.3110"		7.90	.3110"	3-1/4"	1-1/8"	.750"	.301"	6	34.29	32.80	31.31	29.82
96011	.3115"		7.91	.3115"	3-1/4"	1-1/8"	.750"	.302"	6	34.29	32.80	31.31	29.82
96014	.3120"		7.92	.3120"	3-1/4"	1-1/8"	.750"	.302"	6	34.29	32.80	31.31	29.82
96015	.3123"		7.93	.3123"	3-1/4"	1-1/8"	.750"	.302"	6	34.29	32.80	31.31	29.82
96017	.3125"	5/16"	7.93	.3125"	3-1/4"	1-1/8"	.750"	.303"	6	34.29	32.80	31.31	29.82
96021	.3130"		7.95	.3130"	3-1/4"	1-1/8"	.750"	.303"	6	34.29	32.80	31.31	29.82
96023	.3135"		7.96	.3135"	3-1/4"	1-1/8"	.750"	.304"	6	34.29	32.80	31.31	29.82
96026	.3140"		7.97	.3140"	3-1/4"	1-1/8"	.750"	.304"	6	34.29	32.80	31.31	29.82
96029	.3150"		8.00	.3150"	3-1/4"	1-1/8"	.750"	.305"	6	34.29	32.80	31.31	29.82
96032	.3160"	O	8.02	.3160"	3-1/4"	1-1/8"	.750"	.306"	6	34.29	32.80	31.31	29.82
96035	.3170"		8.05	.3170"	3-1/4"	1-1/8"	.750"	.307"	6	34.29	32.80	31.31	29.82
96038	.3180"		8.07	.3180"	3-1/4"	1-1/8"	.750"	.308"	6	34.29	32.80	31.31	29.82
96041	.3190"		8.10	.3190"	3-1/2"	1-1/4"	.750"	.309"	6	42.25	40.41	38.58	36.74
96044	.3200"		8.12	.3200"	3-1/2"	1-1/4"	.750"	.310"	6	42.25	40.41	38.58	36.74
96047	.3210"		8.15	.3210"	3-1/2"	1-1/4"	.750"	.311"	6	42.25	40.41	38.58	36.74

4100 (continued)

.3220" - .3650"
(8.17mm - 9.27mm)

EDP#	d_1 † Diameter		d_2 Shank Diameter	l_1 Overall Length	l_2 Flute Length	l_3 Neck Length	d_3 Neck Diameter	Number Flutes	1-11	12-24	25-49	50-100
	Decimal	Metric										
96050	.3220"	8.17	.3220"	3-1/2"	1-1/4"	.750"	.312"	6	42.25	40.41	38.58	36.74
96053	.3230"	P 8.20	.3230"	3-1/2"	1-1/4"	.750"	.313"	6	42.25	40.41	38.58	36.74
96056	.3240"	8.22	.3240"	3-1/2"	1-1/4"	.750"	.314"	6	42.25	40.41	38.58	36.74
96059	.3250"	8.25	.3250"	3-1/2"	1-1/4"	.750"	.315"	6	42.25	40.41	38.58	36.74
96062	.3260"	8.28	.3260"	3-1/2"	1-1/4"	.750"	.316"	6	42.25	40.41	38.58	36.74
96065	.3270"	8.30	.3270"	3-1/2"	1-1/4"	.750"	.317"	6	42.25	40.41	38.58	36.74
96068	.3280"	8.33	.3280"	3-1/2"	1-1/4"	.750"	.318"	6	42.25	40.41	38.58	36.74
96071	.3281"	21/64" 8.33	.3281"	3-1/2"	1-1/4"	.750"	.318"	6	42.25	40.41	38.58	36.74
96074	.3290"	8.35	.3290"	3-1/2"	1-1/4"	.750"	.319"	6	42.25	40.41	38.58	36.74
96077	.3300"	8.38	.3300"	3-1/2"	1-1/4"	.750"	.320"	6	42.25	40.41	38.58	36.74
96079	.3310"	8.40	.3310"	3-1/2"	1-1/4"	.750"	.321"	6	42.25	40.41	38.58	36.74
96083	.3320"	Q 8.43	.3320"	3-1/2"	1-1/4"	.750"	.322"	6	42.25	40.41	38.58	36.74
96086	.3330"	8.45	.3330"	3-1/2"	1-1/4"	.750"	.323"	6	42.25	40.41	38.58	36.74
96089	.3340"	8.48	.3340"	3-1/2"	1-1/4"	.750"	.324"	6	42.25	40.41	38.58	36.74
96092	.3346"	8.50	.3346"	3-1/2"	1-1/4"	.750"	.325"	6	42.25	40.41	38.58	36.74
96095	.3350"	8.50	.3350"	3-1/2"	1-1/4"	.750"	.325"	6	42.25	40.41	38.58	36.74
96098	.3360"	8.53	.3360"	3-1/2"	1-1/4"	.750"	.326"	6	42.25	40.41	38.58	36.74
96101	.3370"	8.55	.3370"	3-1/2"	1-1/4"	.750"	.327"	6	42.25	40.41	38.58	36.74
96104	.3380"	8.58	.3380"	3-1/2"	1-1/4"	.750"	.328"	6	42.25	40.41	38.58	36.74
96107	.3390"	R 8.61	.3390"	3-1/2"	1-1/4"	.750"	.329"	6	42.25	40.41	38.58	36.74
96110	.3400"	8.63	.3400"	3-1/2"	1-1/4"	.750"	.330"	6	42.25	40.41	38.58	36.74
96113	.3410"	8.66	.3410"	3-1/2"	1-1/4"	.750"	.331"	6	42.25	40.41	38.58	36.74
96116	.3420"	8.68	.3420"	3-1/2"	1-1/4"	.750"	.332"	6	44.72	42.78	40.83	38.89
96119	.3430"	8.71	.3430"	3-1/2"	1-1/4"	.750"	.333"	6	44.72	42.78	40.83	38.89
96122	.3438"	11/32" 8.73	.3438"	3-1/2"	1-1/4"	.750"	.334"	6	44.72	42.78	40.83	38.89
96125	.3440"	8.73	.3440"	3-1/2"	1-1/4"	.750"	.334"	6	44.72	42.78	40.83	38.89
96128	.3450"	8.76	.3450"	3-1/2"	1-1/4"	.750"	.335"	6	44.72	42.78	40.83	38.89
96131	.3460"	8.78	.3460"	3-1/2"	1-1/4"	.750"	.336"	6	44.72	42.78	40.83	38.89
96134	.3470"	8.81	.3470"	3-1/2"	1-1/4"	.750"	.337"	6	44.72	42.78	40.83	38.89
96137	.3480"	S 8.84	.3480"	3-1/2"	1-1/4"	.750"	.338"	6	44.72	42.78	40.83	38.89
96141	.3490"	8.86	.3490"	3-1/2"	1-1/4"	.750"	.339"	6	44.72	42.78	40.83	38.89
96143	.3500"	8.89	.3500"	3-1/2"	1-1/4"	.750"	.340"	6	44.72	42.78	40.83	38.89
96146	.3510"	8.91	.3510"	3-1/2"	1-1/4"	.750"	.341"	6	44.72	42.78	40.83	38.89
96149	.3520"	8.94	.3520"	3-1/2"	1-1/4"	.750"	.342"	6	44.72	42.78	40.83	38.89
96152	.3530"	8.96	.3530"	3-1/2"	1-1/4"	.750"	.343"	6	44.72	42.78	40.83	38.89
96155	.3540"	8.99	.3540"	3-1/2"	1-1/4"	.750"	.344"	6	44.72	42.78	40.83	38.89
96158	.3543"	9.00	.3543"	3-1/2"	1-1/4"	.750"	.344"	6	44.72	42.78	40.83	38.89
96161	.3550"	9.01	.3550"	3-1/2"	1-1/4"	.750"	.345"	6	44.72	42.78	40.83	38.89
96164	.3560"	9.04	.3560"	3-1/2"	1-1/4"	.750"	.346"	6	44.72	42.78	40.83	38.89
96167	.3570"	9.06	.3570"	3-1/2"	1-1/4"	.750"	.347"	6	44.72	42.78	40.83	38.89
96170	.3580"	T 9.09	.3580"	3-1/2"	1-1/4"	.750"	.348"	6	44.72	42.78	40.83	38.89
96173	.3590"	9.11	.3590"	3-1/2"	1-1/4"	.750"	.349"	6	44.72	42.78	40.83	38.89
96176	.3594"	23/64" 9.13	.3594"	3-1/2"	1-1/4"	.750"	.349"	6	44.72	42.78	40.83	38.89
96179	.3600"	9.14	.3600"	3-1/2"	1-1/4"	.750"	.350"	6	44.72	42.78	40.83	38.89
96182	.3610"	9.16	.3610"	3-1/2"	1-1/4"	.750"	.351"	6	44.72	42.78	40.83	38.89
96185	.3620"	9.19	.3620"	3-1/2"	1-1/4"	.750"	.352"	6	44.72	42.78	40.83	38.89
96188	.3630"	9.22	.3630"	3-1/2"	1-1/4"	.750"	.353"	6	46.08	44.08	42.07	40.07
96191	.3640"	9.24	.3640"	3-1/2"	1-1/4"	.750"	.354"	6	46.08	44.08	42.07	40.07
96194	.3650"	9.27	.3650"	3-1/2"	1-1/4"	.750"	.355"	6	46.08	44.08	42.07	40.07

continued →

4100 (continued)

.3660" - .4070"
(9.29mm - 10.33mm)

REAMERS

EDP#	d_1 † Diameter		d_2 Shank Diameter	l_1 Overall Length	l_2 Flute Length	l_3 Neck Length	d_3 Neck Diameter	Number Flutes	1-11	12-24	25-49	50-100
	Decimal	Metric										
96197	.3660"	9.29	.3660"	3-1/2"	1-1/4"	.750"	.356"	6	46.08	44.08	42.07	40.07
96199	.3670"	9.32	.3670"	3-1/2"	1-1/4"	.750"	.357"	6	46.08	44.08	42.07	40.07
96203	.3680"	U 9.35	.3680"	3-1/2"	1-1/4"	.750"	.358"	6	46.08	44.08	42.07	40.07
96206	.3690"	9.37	.3690"	3-1/2"	1-1/4"	.750"	.359"	6	46.08	44.08	42.07	40.07
96209	.3700"	9.39	.3700"	3-1/2"	1-1/4"	.750"	.360"	6	46.08	44.08	42.07	40.07
96212	.3710"	9.42	.3710"	3-1/2"	1-1/4"	.750"	.361"	6	46.08	44.08	42.07	40.07
96215	.3720"	9.44	.3720"	3-1/2"	1-1/4"	.750"	.362"	6	46.08	44.08	42.07	40.07
96218	.3730"	9.47	.3730"	3-1/2"	1-1/4"	.750"	.363"	6	46.08	44.08	42.07	40.07
96221	.3740"	9.50	.3740"	3-1/2"	1-1/4"	.750"	.364"	6	46.08	44.08	42.07	40.07
96224	.3745"	9.51	.3745"	3-1/2"	1-1/4"	.750"	.365"	6	46.08	44.08	42.07	40.07
96225	.3748"	9.52	.3748"	3-1/2"	1-1/4"	.750"	.365"	6	46.08	44.08	42.07	40.07
96227	.3750"	3/8" 9.52	.3750"	3-1/2"	1-1/4"	.750"	.365"	6	46.08	44.08	42.07	40.07
96230	.3755"	9.53	.3755"	3-1/2"	1-1/4"	.750"	.366"	6	46.08	44.08	42.07	40.07
96233	.3760"	9.55	.3760"	3-1/2"	1-1/4"	.750"	.366"	6	46.08	44.08	42.07	40.07
96236	.3765"	9.56	.3765"	3-1/2"	1-1/4"	.750"	.367"	6	46.08	44.08	42.07	40.07
96239	.3770"	V 9.57	.3770"	3-1/2"	1-1/4"	.750"	.367"	6	46.08	44.08	42.07	40.07
96242	.3780"	9.60	.3780"	3-1/2"	1-1/4"	.750"	.368"	6	54.04	51.69	49.34	46.99
96245	.3790"	9.62	.3790"	3-1/2"	1-1/4"	.750"	.369"	6	54.04	51.69	49.34	46.99
96248	.3800"	9.65	.3800"	3-1/2"	1-1/4"	.750"	.370"	6	54.04	51.69	49.34	46.99
96251	.3810"	9.67	.3810"	3-1/2"	1-1/4"	.750"	.371"	6	54.04	51.69	49.34	46.99
96254	.3820"	9.70	.3820"	3-1/2"	1-1/4"	.750"	.372"	6	54.04	51.69	49.34	46.99
96257	.3830"	9.72	.3830"	3-1/2"	1-1/4"	.750"	.373"	6	54.04	51.69	49.34	46.99
96260	.3840"	9.75	.3840"	3-1/2"	1-1/4"	.750"	.374"	6	54.04	51.69	49.34	46.99
96263	.3850"	9.77	.3850"	3-1/2"	1-1/4"	.750"	.375"	6	54.04	51.69	49.34	46.99
96266	.3860"	W 9.80	.3860"	3-1/2"	1-1/4"	.750"	.376"	6	54.04	51.69	49.34	46.99
96269	.3870"	9.82	.3870"	3-1/2"	1-1/4"	.750"	.377"	6	54.04	51.69	49.34	46.99
96272	.3880"	9.85	.3880"	3-1/2"	1-1/4"	.750"	.378"	6	54.04	51.69	49.34	46.99
96275	.3890"	9.88	.3890"	3-1/2"	1-1/4"	.750"	.379"	6	54.04	51.69	49.34	46.99
96278	.3900"	9.90	.3900"	3-1/2"	1-1/4"	.750"	.380"	6	54.04	51.69	49.34	46.99
96281	.3906"	25/64" 9.92	.3906"	3-1/2"	1-1/4"	.750"	.381"	6	54.04	51.69	49.34	46.99
96284	.3910"	9.93	.3910"	3-1/2"	1-1/4"	.750"	.381"	6	54.04	51.69	49.34	46.99
96287	.3920"	9.95	.3920"	3-1/2"	1-1/4"	.750"	.382"	6	54.04	51.69	49.34	46.99
96290	.3930"	9.98	.3930"	3-1/2"	1-1/4"	.750"	.383"	6	54.04	51.69	49.34	46.99
96293	.3937"	10.00	.3937"	3-1/2"	1-1/4"	.750"	.384"	6	55.95	53.52	51.08	48.65
96296	.3940"	10.01	.3940"	3-1/2"	1-1/4"	.750"	.384"	6	55.95	53.52	51.08	48.65
96299	.3950"	10.03	.3950"	3-1/2"	1-1/4"	.750"	.385"	6	55.95	53.52	51.08	48.65
96302	.3960"	10.05	.3960"	3-1/2"	1-1/4"	.750"	.386"	6	55.95	53.52	51.08	48.65
96305	.3970"	X 10.08	.3970"	3-1/2"	1-1/4"	.750"	.387"	6	55.95	53.52	51.08	48.65
96308	.3980"	10.10	.3980"	3-1/2"	1-1/4"	.750"	.388"	6	55.95	53.52	51.08	48.65
96311	.3990"	10.13	.3990"	3-1/2"	1-1/4"	.750"	.389"	6	55.95	53.52	51.08	48.65
96314	.4000"	10.16	.4000"	3-1/2"	1-1/4"	.750"	.390"	6	55.95	53.52	51.08	48.65
96317	.4010"	10.18	.4010"	3-1/2"	1-1/4"	.750"	.391"	6	55.95	53.52	51.08	48.65
96319	.4020"	10.21	.4020"	3-1/2"	1-1/4"	.750"	.392"	6	55.95	53.52	51.08	48.65
96323	.4030"	10.23	.4030"	3-1/2"	1-1/4"	.750"	.393"	6	55.95	53.52	51.08	48.65
96326	.4040"	Y 10.26	.4040"	3-1/2"	1-1/4"	.750"	.394"	6	55.95	53.52	51.08	48.65
96329	.4050"	10.28	.4050"	3-1/2"	1-1/4"	.750"	.395"	6	55.95	53.52	51.08	48.65
96332	.4060"	10.31	.4060"	3-1/2"	1-1/4"	.750"	.396"	6	55.95	53.52	51.08	48.65
96335	.4062"	13/32" 10.31	.4062"	3-1/2"	1-1/4"	.750"	.396"	6	55.95	53.52	51.08	48.65
96338	.4070"	10.33	.4070"	3-1/2"	1-1/4"	.750"	.397"	6	55.95	53.52	51.08	48.65

4100 (continued)

.4080" - .4490"
(10.36mm - 11.40mm)

EDP#	d_1 † Diameter		d_2 Shank Diameter	l_1 Overall Length	l_2 Flute Length	l_3 Neck Length	d_3 Neck Diameter	Number Flutes	1-11	12-24	25-49	50-100
	Decimal	Metric										
96341	.4080"	10.36	.4080"	3-1/2"	1-1/4"	.750"	.398"	6	55.95	53.52	51.08	48.65
96344	.4090"	10.38	.4090"	3-1/2"	1-1/4"	.750"	.399"	6	55.95	53.52	51.08	48.65
96347	.4100"	10.41	.4100"	3-1/2"	1-1/4"	.750"	.400"	6	55.95	53.52	51.08	48.65
96350	.4110"	10.43	.4110"	3-1/2"	1-1/4"	.750"	.401"	6	57.91	55.39	52.87	50.36
96353	.4120"	10.46	.4120"	3-1/2"	1-1/4"	.750"	.402"	6	57.91	55.39	52.87	50.36
96356	.4130"	Z 10.49	.4130"	3-1/2"	1-1/4"	.750"	.403"	6	57.91	55.39	52.87	50.36
96359	.4134"	10.50	.4134"	3-1/2"	1-1/4"	.750"	.403"	6	57.91	55.39	52.87	50.36
96362	.4140"	10.51	.4140"	3-1/2"	1-1/4"	.750"	.404"	6	57.91	55.39	52.87	50.36
96365	.4150"	10.54	.4150"	3-1/2"	1-1/4"	.750"	.405"	6	57.91	55.39	52.87	50.36
96366	.4160"	10.56	.4160"	4"	1-3/8"	.750"	.406"	6	57.91	55.39	52.87	50.36
96367	.4170"	10.59	.4170"	4"	1-3/8"	.750"	.407"	6	57.91	55.39	52.87	50.36
96368	.4180"	10.61	.4180"	4"	1-3/8"	.750"	.408"	6	57.91	55.39	52.87	50.36
96369	.4190"	10.64	.4190"	4"	1-3/8"	.750"	.409"	6	57.91	55.39	52.87	50.36
96371	.4200"	10.66	.4200"	4"	1-3/8"	.750"	.410"	6	57.91	55.39	52.87	50.36
96374	.4210"	10.69	.4210"	4"	1-3/8"	.750"	.411"	6	57.91	55.39	52.87	50.36
96377	.4219"	27/64" 10.72	.4219"	4"	1-3/8"	.750"	.412"	6	57.91	55.39	52.87	50.36
96380	.4220"	10.71	.4220"	4"	1-3/8"	.750"	.412"	6	57.91	55.39	52.87	50.36
96383	.4230"	10.74	.4230"	4"	1-3/8"	.750"	.413"	6	57.91	55.39	52.87	50.36
96386	.4240"	10.76	.4240"	4"	1-3/8"	.750"	.414"	6	57.91	55.39	52.87	50.36
96389	.4250"	10.79	.4250"	4"	1-3/8"	.750"	.415"	6	57.91	55.39	52.87	50.36
96392	.4260"	10.82	.4260"	4"	1-3/8"	.750"	.416"	6	57.91	55.39	52.87	50.36
96395	.4270"	10.84	.4270"	4"	1-3/8"	.750"	.417"	6	57.91	55.39	52.87	50.36
96398	.4280"	10.87	.4280"	4"	1-3/8"	.750"	.418"	6	57.91	55.39	52.87	50.36
96401	.4290"	10.89	.4290"	4"	1-3/8"	.750"	.419"	6	57.91	55.39	52.87	50.36
96404	.4300"	10.92	.4300"	4"	1-3/8"	.750"	.420"	6	57.91	55.39	52.87	50.36
96407	.4310"	10.94	.4310"	4"	1-3/8"	.750"	.421"	6	57.91	55.39	52.87	50.36
96410	.4320"	10.97	.4320"	4"	1-3/8"	.750"	.422"	6	57.91	55.39	52.87	50.36
96413	.4330"	10.99	.4330"	4"	1-3/8"	.750"	.423"	6	57.91	55.39	52.87	50.36
96416	.4331"	11.00	.4331"	4"	1-3/8"	.750"	.423"	6	57.91	55.39	52.87	50.36
96419	.4340"	11.02	.4340"	4"	1-3/8"	.750"	.424"	6	57.91	55.39	52.87	50.36
96422	.4350"	11.04	.4350"	4"	1-3/8"	.750"	.425"	6	57.91	55.39	52.87	50.36
96425	.4360"	11.07	.4360"	4"	1-3/8"	.750"	.426"	6	57.91	55.39	52.87	50.36
96428	.4365"	11.08	.4365"	4"	1-3/8"	.750"	.427"	6	57.91	55.39	52.87	50.36
96431	.4370"	11.10	.4370"	4"	1-3/8"	.750"	.427"	6	57.91	55.39	52.87	50.36
96432	.4373"	11.10	.4373"	4"	1-3/8"	.750"	.427"	6	57.91	55.39	52.87	50.36
96434	.4375"	7/16" 11.11	.4375"	4"	1-3/8"	.750"	.428"	6	57.91	55.39	52.87	50.36
96437	.4380"	11.12	.4380"	4"	1-3/8"	.750"	.428"	6	62.08	59.38	56.68	53.98
96440	.4385"	11.13	.4385"	4"	1-3/8"	.750"	.429"	6	62.08	59.38	56.68	53.98
96443	.4390"	11.15	.4390"	4"	1-3/8"	.750"	.429"	6	62.08	59.38	56.68	53.98
96446	.4400"	11.17	.4400"	4"	1-3/8"	.750"	.430"	6	62.08	59.38	56.68	53.98
96449	.4410"	11.20	.4410"	4"	1-3/8"	.750"	.431"	6	62.08	59.38	56.68	53.98
96452	.4420"	11.22	.4420"	4"	1-3/8"	.750"	.432"	6	62.08	59.38	56.68	53.98
96455	.4430"	11.25	.4430"	4"	1-3/8"	.750"	.433"	6	62.08	59.38	56.68	53.98
96458	.4440"	11.27	.4440"	4"	1-3/8"	.750"	.434"	6	62.08	59.38	56.68	53.98
96461	.4450"	11.30	.4450"	4"	1-3/8"	.750"	.435"	6	62.08	59.38	56.68	53.98
96464	.4460"	11.32	.4460"	4"	1-3/8"	.750"	.436"	6	62.08	59.38	56.68	53.98
96467	.4470"	11.35	.4470"	4"	1-3/8"	.750"	.437"	6	62.08	59.38	56.68	53.98
96470	.4480"	11.37	.4480"	4"	1-3/8"	.750"	.438"	6	62.08	59.38	56.68	53.98
96473	.4490"	11.40	.4490"	4"	1-3/8"	.750"	.439"	6	62.08	59.38	56.68	53.98

continued →

4100 (continued)

.4500" - .4921"
(11.43mm - 12.50mm)

REAMERS

EDP#	d_1 † Diameter		d_2 Shank Diameter	l_1 Overall Length	l_2 Flute Length	l_3 Neck Length	d_3 Neck Diameter	Number Flutes	1-11	12-24	25-49	50-100	
	Decimal	Metric											
96476	.4500"	11.43	.4500"	4"	1-3/8"	.750"	.440"	6	62.08	59.38	56.68	53.98	
96479	.4510"	11.45	.4510"	4"	1-3/8"	.750"	.441"	6	62.08	59.38	56.68	53.98	
96482	.4520"	11.48	.4520"	4"	1-3/8"	.750"	.442"	6	62.08	59.38	56.68	53.98	
96485	.4528"	11.50	.4528"	4"	1-3/8"	.750"	.443"	6	62.08	59.38	56.68	53.98	
96488	.4530"	11.50	.4530"	4"	1-3/8"	.750"	.443"	6	62.08	59.38	56.68	53.98	
96491	.4531"	29/64"	11.51	.4531"	4"	1-3/8"	.750"	.443"	6	62.08	59.38	56.68	53.98
96494	.4540"	11.53	.4540"	4"	1-3/8"	.750"	.444"	6	62.08	59.38	56.68	53.98	
96497	.4550"	11.55	.4550"	4"	1-3/8"	.750"	.445"	6	62.08	59.38	56.68	53.98	
96500	.4560"	11.58	.4560"	4"	1-3/8"	.750"	.446"	6	62.08	59.38	56.68	53.98	
96503	.4570"	11.60	.4570"	4"	1-3/8"	.750"	.447"	6	62.08	59.38	56.68	53.98	
96506	.4580"	11.63	.4580"	4"	1-3/8"	.750"	.448"	6	62.08	59.38	56.68	53.98	
96509	.4590"	11.65	.4590"	4"	1-3/8"	.750"	.449"	6	62.08	59.38	56.68	53.98	
96512	.4600"	11.68	.4600"	4"	1-3/8"	.750"	.450"	6	62.08	59.38	56.68	53.98	
96515	.4610"	11.70	.4610"	4"	1-3/8"	.750"	.451"	6	63.94	61.16	58.38	55.60	
96518	.4620"	11.73	.4620"	4"	1-3/8"	.750"	.452"	6	63.94	61.16	58.38	55.60	
96521	.4630"	11.76	.4630"	4"	1-3/8"	.750"	.453"	6	63.94	61.16	58.38	55.60	
96524	.4640"	11.78	.4640"	4"	1-3/8"	.750"	.454"	6	63.94	61.16	58.38	55.60	
96527	.4650"	11.81	.4650"	4"	1-3/8"	.750"	.455"	6	63.94	61.16	58.38	55.60	
96530	.4660"	11.83	.4660"	4"	1-3/8"	.750"	.456"	6	63.94	61.16	58.38	55.60	
96533	.4670"	11.86	.4670"	4"	1-3/8"	.750"	.457"	6	63.94	61.16	58.38	55.60	
96536	.4680"	11.88	.4680"	4"	1-3/8"	.750"	.458"	6	63.94	61.16	58.38	55.60	
96539	.4688"	15/32"	11.91	.4688"	4"	1-3/8"	.750"	.459"	6	63.94	61.16	58.38	55.60
96542	.4690"	11.91	.4690"	4"	1-3/8"	.750"	.459"	6	63.94	61.16	58.38	55.60	
96545	.4700"	11.93	.4700"	4"	1-1/2"	.750"	.460"	6	63.94	61.16	58.38	55.60	
96548	.4710"	11.96	.4710"	4"	1-1/2"	.750"	.461"	6	63.94	61.16	58.38	55.60	
96551	.4720"	11.98	.4720"	4"	1-1/2"	.750"	.462"	6	63.94	61.16	58.38	55.60	
96554	.4724"	12.00	.4724"	4"	1-1/2"	.750"	.462"	6	63.94	61.16	58.38	55.60	
96557	.4730"	12.01	.4730"	4"	1-1/2"	.750"	.463"	6	63.94	61.16	58.38	55.60	
96561	.4740"	12.03	.4740"	4"	1-1/2"	.750"	.464"	6	63.94	61.16	58.38	55.60	
96563	.4750"	12.06	.4750"	4"	1-1/2"	.750"	.465"	6	63.94	61.16	58.38	55.60	
96566	.4760"	12.09	.4760"	4"	1-1/2"	.750"	.466"	6	63.94	61.16	58.38	55.60	
96569	.4770"	12.11	.4770"	4"	1-1/2"	.750"	.467"	6	63.94	61.16	58.38	55.60	
96572	.4780"	12.14	.4780"	4"	1-1/2"	.750"	.468"	6	63.94	61.16	58.38	55.60	
96575	.4790"	12.16	.4790"	4"	1-1/2"	.750"	.469"	6	63.94	61.16	58.38	55.60	
96578	.4800"	12.19	.4800"	4"	1-1/2"	.750"	.470"	6	65.34	62.50	59.66	56.82	
96581	.4810"	12.21	.4810"	4"	1-1/2"	.750"	.471"	6	65.34	62.50	59.66	56.82	
96584	.4820"	12.24	.4820"	4"	1-1/2"	.750"	.472"	6	65.34	62.50	59.66	56.82	
96587	.4830"	12.26	.4830"	4"	1-1/2"	.750"	.473"	6	65.34	62.50	59.66	56.82	
96590	.4840"	12.29	.4840"	4"	1-1/2"	.750"	.474"	6	65.34	62.50	59.66	56.82	
96593	.4844"	31/64"	12.30	.4844"	4"	1-1/2"	.750"	.474"	6	65.34	62.50	59.66	56.82
96596	.4850"	12.31	.4850"	4"	1-1/2"	.750"	.475"	6	65.34	62.50	59.66	56.82	
96599	.4860"	12.34	.4860"	4"	1-1/2"	.750"	.476"	6	65.34	62.50	59.66	56.82	
96602	.4870"	12.36	.4870"	4"	1-1/2"	.750"	.477"	6	65.34	62.50	59.66	56.82	
96605	.4880"	12.39	.4880"	4"	1-1/2"	.750"	.478"	6	65.34	62.50	59.66	56.82	
96608	.4890"	12.42	.4890"	4"	1-1/2"	.750"	.479"	6	65.34	62.50	59.66	56.82	
96611	.4900"	12.44	.4900"	4"	1-1/2"	.750"	.480"	6	65.34	62.50	59.66	56.82	
96614	.4910"	12.47	.4910"	4"	1-1/2"	.750"	.481"	6	65.34	62.50	59.66	56.82	
96617	.4920"	12.49	.4920"	4"	1-1/2"	.750"	.482"	6	65.34	62.50	59.66	56.82	
96620	.4921"	12.50	.4921"	4"	1-1/2"	.750"	.482"	6	65.34	62.50	59.66	56.82	

4100 (continued)

.4930" - .5020"
(12.52mm - 12.75mm)

EDP#	d_1 † Diameter		d_2 Shank Diameter	l_1 Overall Length	l_2 Flute Length	l_3 Neck Length	d_3 Neck Diameter	Number Flutes	1-11	12-24	25-49	50-100
	Decimal	Metric										
96623	.4930"	12.52	.4930"	4"	1-1/2"	.750"	.483"	6	65.34	62.50	59.66	56.82
96626	.4940"	12.54	.4940"	4"	1-1/2"	.750"	.484"	6	65.34	62.50	59.66	56.82
96629	.4950"	12.57	.4950"	4"	1-1/2"	.750"	.485"	6	65.34	62.50	59.66	56.82
96632	.4960"	12.59	.4960"	4"	1-1/2"	.750"	.486"	6	65.34	62.50	59.66	56.82
96635	.4970"	12.62	.4970"	4"	1-1/2"	.750"	.487"	6	65.34	62.50	59.66	56.82
96638	.4980"	12.64	.4980"	4"	1-1/2"	.750"	.488"	6	65.34	62.50	59.66	56.82
96641	.4990"	12.67	.4990"	4"	1-1/2"	.750"	.489"	6	65.34	62.50	59.66	56.82
96644	.4995"	12.68	.4995"	4"	1-1/2"	.750"	.490"	6	65.34	62.50	59.66	56.82
96645	.4998"	12.69	.4998"	4"	1-1/2"	.750"	.490"	6	65.34	62.50	59.66	56.82
96647	.5000"	12.70	.5000"	4"	1-1/2"	.750"	.490"	6	65.34	62.50	59.66	56.82
96650	.5005"	12.71	.5005"	4"	1-1/2"	.750"	.491"	6	65.34	62.50	59.66	56.82
96653	.5010"	12.72	.5010"	4"	1-1/2"	.750"	.491"	6	65.34	62.50	59.66	56.82
96656	.5020"	12.75	.5020"	4"	1-1/2"	.750"	.492"	6	65.34	62.50	59.66	56.82



LHS / RHC

STR / RHC

RHS / RHC

Special Reamers - Solid Carbide - 2 Week Delivery

Solid Carbide Submicron Grain
All reamers furnished with a standard 45° Lead Chamfer

Diameter		Overall Length	Flute Length	No. of Flutes
Decimal	Metric			
.0590" - .0650"	1.49 - 1.65	1-1/2"	3/8"	4
.0660" - .0800"	1.67 - 2.03	1-3/4"	1/2"	4
.0810" - .0950"	2.05 - 2.41	2"	1/2"	4
.0960" - .1300"	2.43 - 3.30	2-1/4"	5/8"	4
.1310" - .1590"	3.32 - 4.03	2-1/2"	3/4"	4
.1600" - .1950"	4.06 - 4.95	2-3/4"	7/8"	4
.1960" - .2540"	4.97 - 6.45	3"	1"	4
.2550" - .3180"	6.47 - 8.07	3-1/4"	1-1/8"	6
.3190" - .4150"	8.10 - 10.54	3-1/2"	1-1/4"	6
.4160" - .4690"	10.56 - 11.91	4"	1-3/8"	6
.4700" - .5020"	11.93 - 12.75	4"	1-1/2"	6
.5030" - .5700"	12.77 - 14.47	4"	1-5/8"	6
.5710" - .7500"	14.50 - 19.05	4"	1-3/4"	6

GARR TOOL Reaming Guide

Type	Rc Hardness	Recommended SFM	Chipload Per Tooth (Fz)			
		Series 4100	.0590" - .1250"	.1251" - .2500"	.2501" - .3750"	.3751" - .5020"
COBALT BASE ALLOYS						
Powdered Metal, Stellite, Hs-21, Haynes 25/188, X-40, L-605	< 35 > 35	80-120 60-80	.0003"-.0008"	.0005"-.0010"	.0008"-.0012"	.0010"-.0015"
NICKEL BASE ALLOYS						
Invar, Kovar, Inconel-625/718, Waspalloy, Rene, Hastalloy, A286	< 35 > 35	100-125 80-110	.0003"-.0008"	.0005"-.0010"	.0008"-.0012"	.0010"-.0015"
IRON BASE ALLOYS						
Incoloy 800-802, Multimet N-155, Timkin 16-25-6, Carpenter 22-b3	< 35 > 35	150-175 120-150	.0004"-.0009"	.0006"-.0012"	.0009"-.0013"	.0010"-.0017"
MONEL						
Monel - 65% Nickel		75-110	.0003"-.0008"	.0005"-.0010"	.0008"-.0012"	.0010"-.0015"
TITANIUM ALLOYS						
Commercially Pure, 6Al-4V, Astm 1/2/3, 6Al-25N-4Zr-2Mo-Si		120-150	.0004"-.0009"	.0006"-.0012"	.0009"-.0013"	.0010"-.0017"
STAINLESS STEELS						
(Precipitation) 13/8, 15/5, 17-4, pH Types	< 35 > 35	100-125 80-110	.0004"-.0009"	.0006"-.0012"	.0009"-.0013"	.0010"-.0017"
(Austenitic) Inox, 200 Series, 300 Series	< 35 > 35	100-125 80-110	.0004"-.0009"	.0006"-.0012"	.0009"-.0013"	.0010"-.0017"
(Austenitic) 304L, 316L, Nitronic 50, Inox	< 35 > 35	80-100 60-80	.0003"-.0008"	.0005"-.0010"	.0008"-.0012"	.0010"-.0015"
(Martensitic) 400 Series	< 35 > 35	100-125 80-110	.0004"-.0009"	.0006"-.0012"	.0009"-.0013"	.0010"-.0017"
HIGH STRENGTH TOOL STEELS						
4140, 4340, 6150, 5210, A2, D2, P20, H11, H13, S2, O1	< 35 > 35	100-125 80-110	.0003"-.0008"	.0005"-.0010"	.0008"-.0012"	.0010"-.0015"
MEDIUM ALLOY TOOL STEELS						
200, 250, 300, 8620	< 35 > 35	100-125 80-110	.0004"-.0009"	.0006"-.0012"	.0009"-.0013"	.0010"-.0017"
CARBON STEELS						
Platinum, A36, 12L14, 1000's, 1100's, 1300's	< 35 > 35	100-125 80-110	.0004"-.0009"	.0006"-.0012"	.0009"-.0013"	.0010"-.0017"
CAST MATERIAL						
Steel		125-150	.0003"-.0008"	.0005"-.0010"	.0008"-.0012"	.0010"-.0015"
Ductile Iron		150-225	.0005"-.0010"	.0007"-.0012"	.0010"-.0015"	.0010"-.0018"
Gray Iron		125-200	.0005"-.0010"	.0007"-.0012"	.0010"-.0015"	.0010"-.0018"
Aluminum		150-225	.0005"-.0010"	.0007"-.0012"	.0010"-.0015"	.0010"-.0018"
ALUMINUM						
Aircraft Grade (6061, 7075)		225	.0005"-.0010"	.0007"-.0012"	.0010"-.0015"	.0010"-.0018"
MAGNESIUM						
		225	.0005"-.0010"	.0007"-.0012"	.0010"-.0015"	.0010"-.0018"
COPPER						
Copper Alloys		225	.0005"-.0010"	.0007"-.0012"	.0010"-.0015"	.0010"-.0018"
BRASS, BRONZE						
Brass, Aluminum/Bronze, Low Silicon Bronze		125-200	.0005"-.0010"	.0007"-.0012"	.0010"-.0015"	.0010"-.0018"
COMPOSITE MATERIAL						
Glass Epoxy, Fiberglass, Plastics, Graphite, G10		150	.0003"-.0008"	.0005"-.0010"	.0008"-.0012"	.0010"-.0015"

NOTE - ABOVE ARE STARTING PARAMETERS ONLY. HIGHER RESULTS MAY BE ACHIEVED WITH OPTIMUM CONDITIONS.

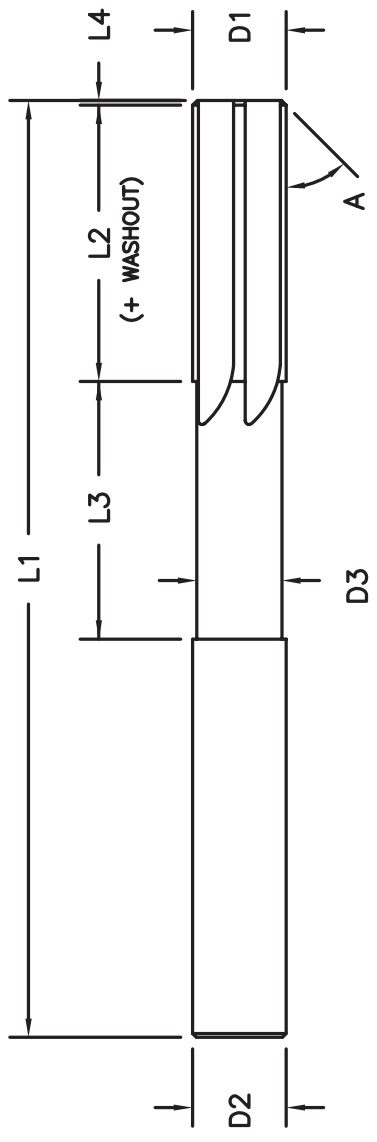

D1: _____ TOL: _____
 D2: _____ TOL: _____
 D3: _____
 L1: _____
 L2: _____
 L3: _____
 L4 (CHAMFER LENGTH): _____
 A (CHAMFER ANGLE): _____
 NO. FLUTES (STR/RHC): _____
 COATING: _____
 MAT'L BEING CUT: _____

DIMENSIONS NOT SHOWN TO BE GARR TOOL STANDARDS
 TOLERANCES ARE BEFORE ANY COATING IS APPLIED

GARR TOOL
 ALMA, MICHIGAN

SCALE:	DRAWN BY:	APPR. BY:
DATE:		DATE:

TITLE: REAMER

CUSTOMER: _____ DWG NO.: _____

REVISIONS

GARR TOOL®

7800 N Alger Road
P.O. Box 489
Alma, Michigan 48801
800-248-9003
989-463-6171
Fax 989-463-3609
Supplement 091R

www.garrtool.com

Sold through select industrial distributors
Prices subject to change without notice

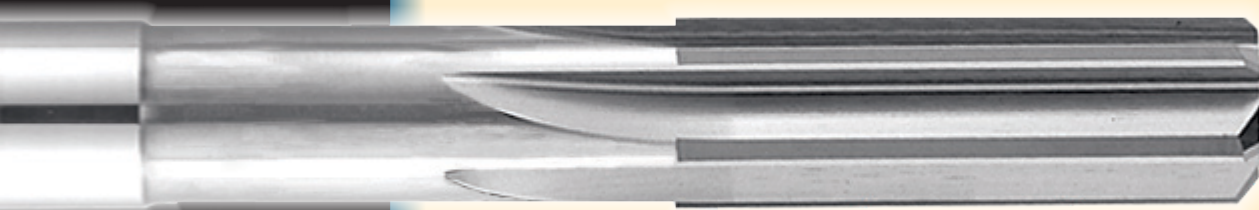

GARR TOOL®

Copyright©2009 by Garr Tool Company, Alma, Michigan, USA.
All Rights Reserved. No part of this publication may be reproduced
in any form or by any means without prior written permission from Garr Tool Company.
Garr Tool Company makes every effort to ensure accuracy in its publications.
We are not responsible for errors in printing should they occur.
Printed in the United States.